



180kg Magnetic Lock

# 180kg Magnetic Lock Manual

## Specification

Model	Size(unit:mm)	Voltage	Current	Holding Force	Signal Output	Door
YM-180	170Lx41.4Wx20.5H	12/24VDC	12V/300mA 24V/150mA	180kg(350Lbs)	No	Single Door
YM-180D	340Lx41.4Wx20.5H	12/24VDC	12V/300mA 24V/150mA	180kgx2(350Lbsx2)	No	Double Door
YM-180-S	183Lx41.4Wx20.5H	12/24VDC	12V/300mA 24V/150mA	180kg(350Lbs)	Yes	Single Door
YM-180D-S	366Lx41.4Wx20.5H	12/24VDC	12V/300mA 24V/150mA	180kgx2(350Lbsx2)	Yes	Double Door

## Diagram (unit:mm)

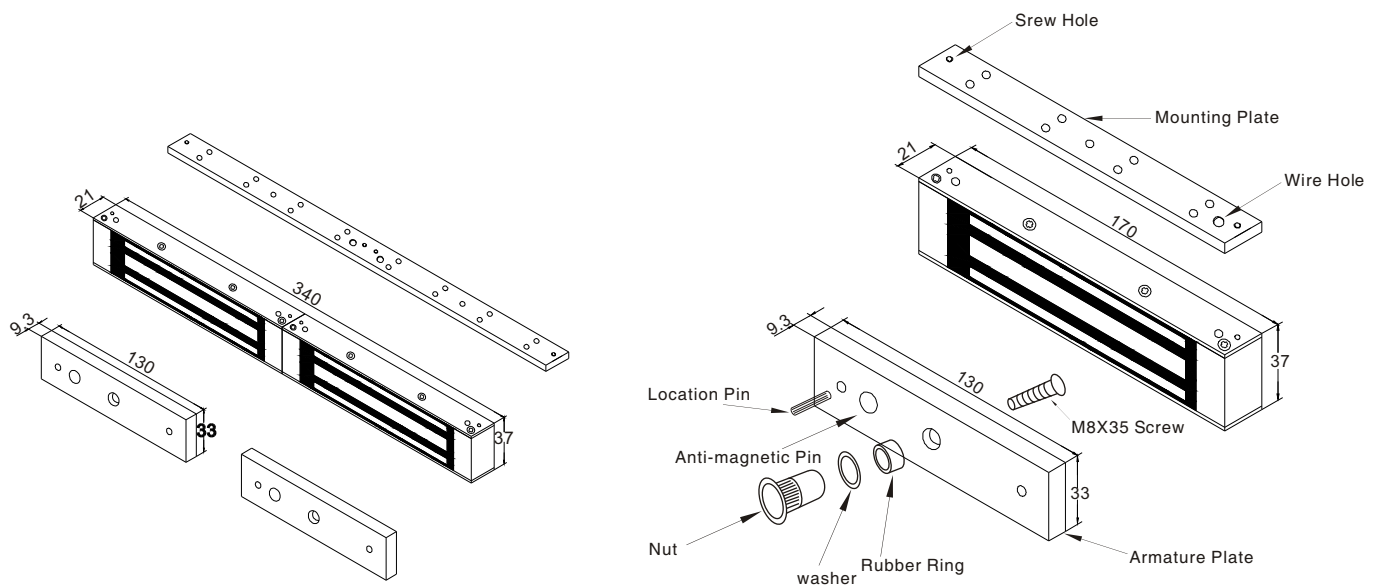

### ⚠ Remark:

A: Please don't fix the screw(screw of armature plate) tightly, let the rubber ring maintain proper elasticity.

B: Please check the jumper position, to know voltage is 12VDC or 24VDC.



# 180kg Magnetic Lock

## Installation

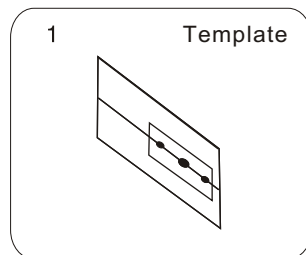
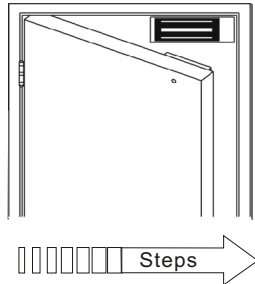

Flod the template to 90°

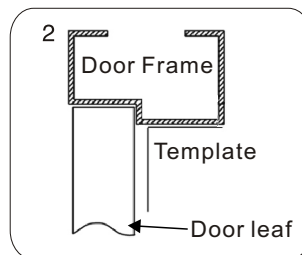

Close the door, place the template on door frame, close to door leaf.

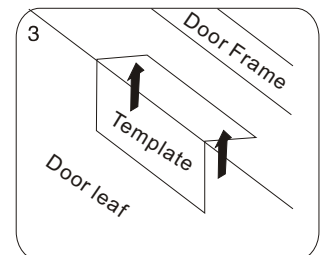

Mark screw positions on door leaf and door frame.

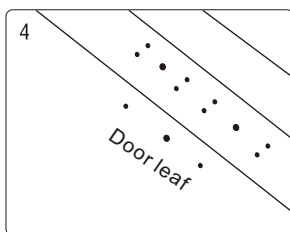

Drill holes on the marked positions

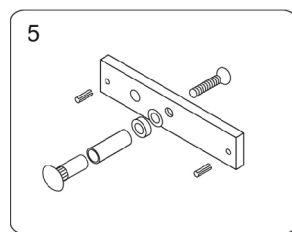

Install the Armature Plate on door leaf

Hollow Matel Door

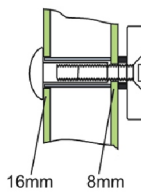

Drill a hole  
Inside: Diameter is 8mm  
Outside: Diameter is 16mm

Wooden Door

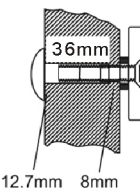

Drill a hole  
Inside: Diameter is 8mm  
Outside: Diameter is 12.7mm

Matel Surface Door

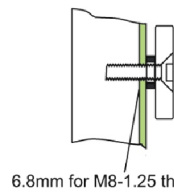

Inside: Drill a hole diameter is 8mm folding the plastic straight pin

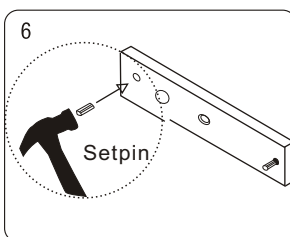

Put the pin into the Armature Plate

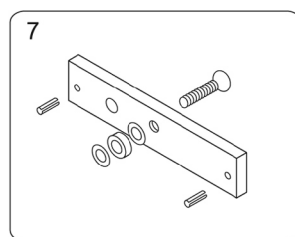

According to the picture add the washers on the Armature Plate.

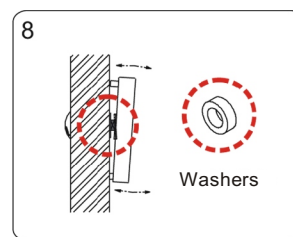

Plase washers between Armature plate and door leaf

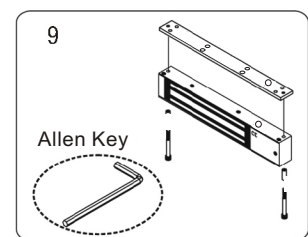

Use Allen Key to remove the Mounting plate from lock body

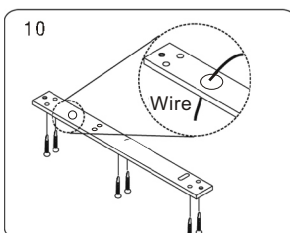

Wire go through the wire hole, then screw the mounting plate on top of the door frame.

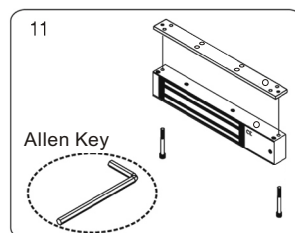

Use Allen Key to screw the lock body on the mounting plate.

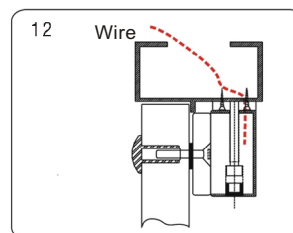

Close and pull the door to test holding force, extra washers can be added to adjust anfle between door leaf and armature plate.

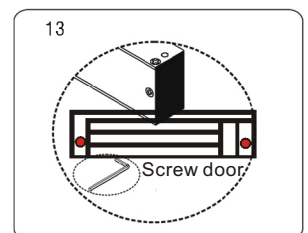

Confirm the holding force and tighten the proof screws



180kg Magnetic Lock

## Bracket Installation

Different brackets are available according to different types of doors. For example, narrow door frame door, frameless glass door and inward opening door.

### L Bracket

When the door frame thickness is less than 42mm, need to install the L bracket.

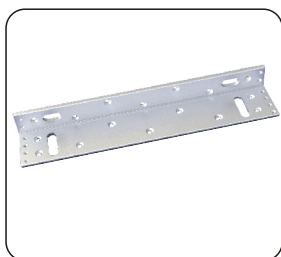
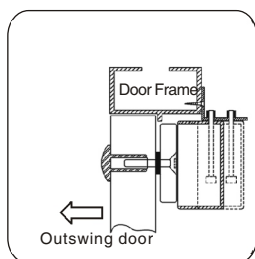

### ZL Bracket

For inward opening door, need to install the ZL bracket.

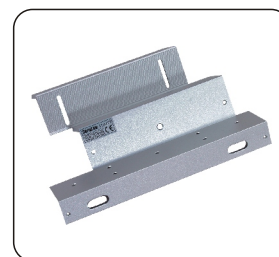
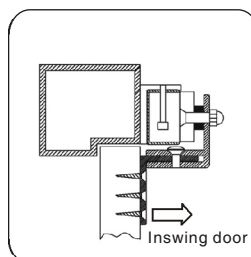

### U Bracket

For the frameless glass door, need to install the UL bracket.  
(suitable for 10-15mm glassdoor).

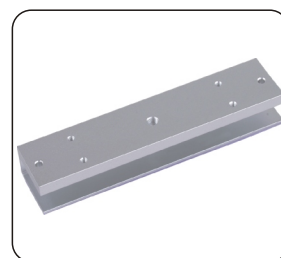
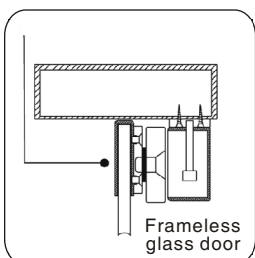

### Bracket for Amature Plate

When the door frame is too thick, need to install the I bracket.

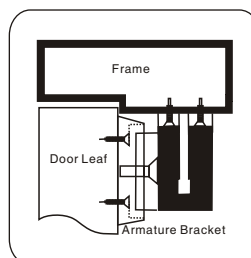

## Installation Instruction

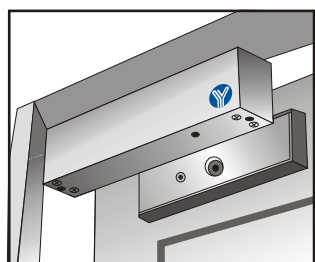

I Bracket Installation

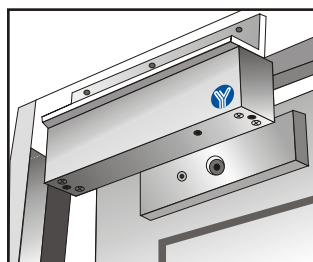

L Bracket Installation

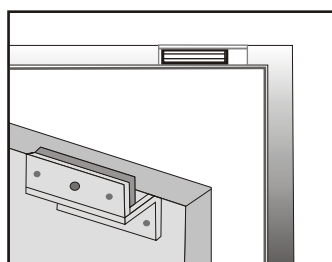

ZL Bracket Installation

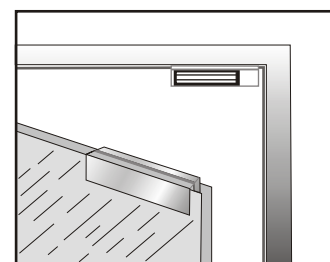

UL Bracket Installation



## 180kg Magnetic Lock

### Circuit Board Diagram

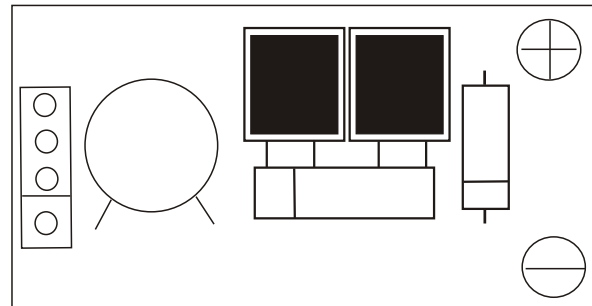
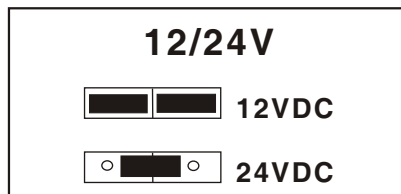

### Wire Connection

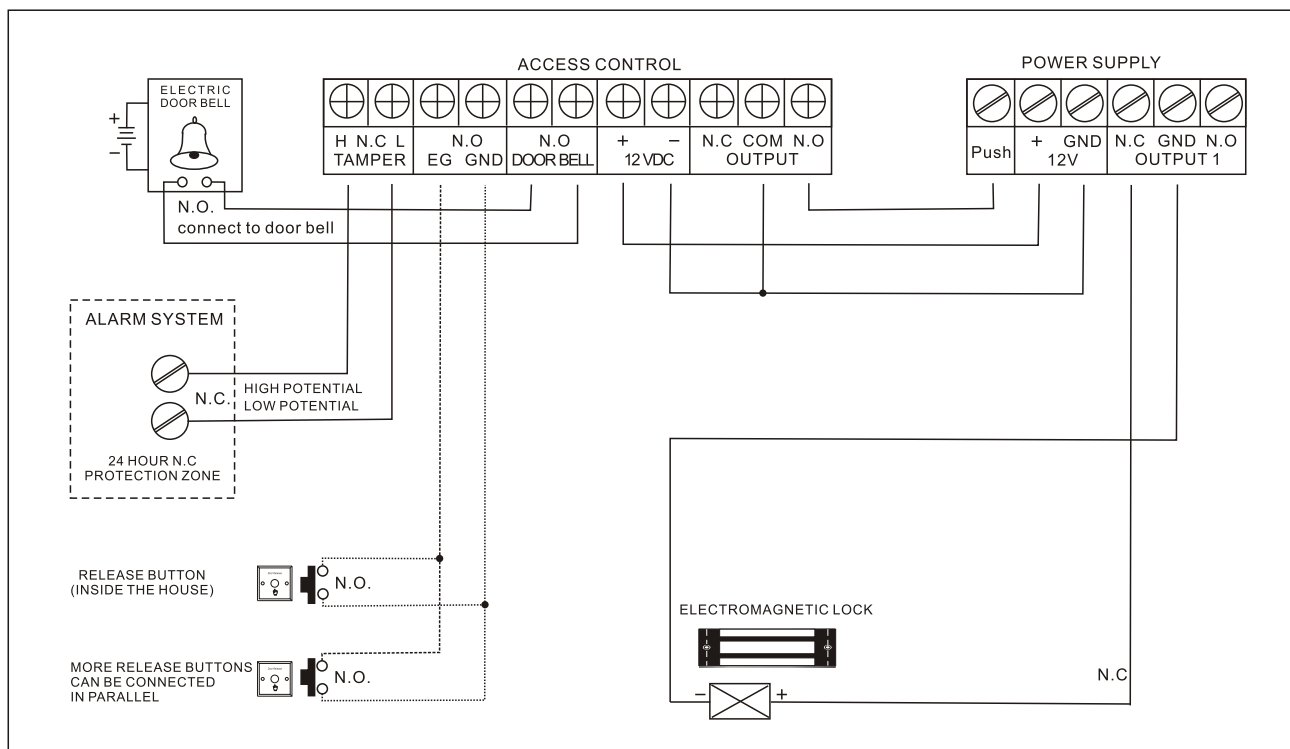

#### NOTE:

Please Read Specification Before Attempting To Install Magnetic Lock

- Handle the equipment with care, damaging the mating surfaces of the magnet or armature plate may reduce locking efficiency.
- The magnet mounts rigidly to the door frame. The armature plate mounts to the door with hardware. Kit provided that allows it to pivot about its center to compensate for door wear and misalignment.
- Template must take place with the door in its normally closed position.
- Please tuist screws of magnetic lock firmly
- E.Detect signal of Door stute:The Limit of Dry reed and Dry contact is 0.5A/30VDC,Don,t overload.